

# Panama Court

742 & 785 Dorchester Avenue, Winnipeg

**TYPE F**  
827 sq feet  
2 Bedroom

- Spacious living and dining area
- Front and back door
- Hardwood floors
- Ample storage
- Large pantry
- Suites with character
- Fridge and stove

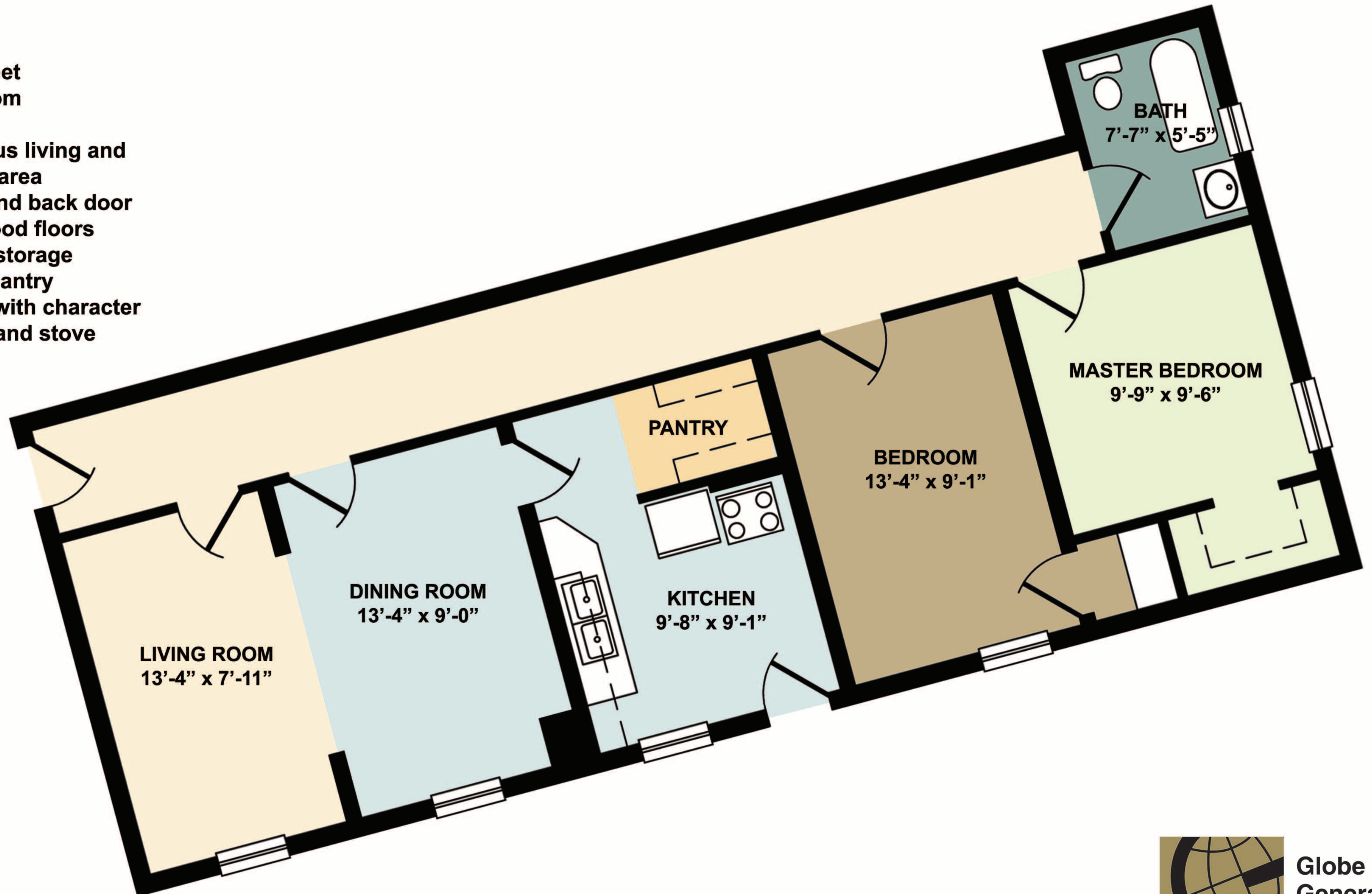

[www.globegeneral.ca](http://www.globegeneral.ca)



Globe  
General  
Agencies